

CB10 Compact 2-way Battery Powered Loudspeaker

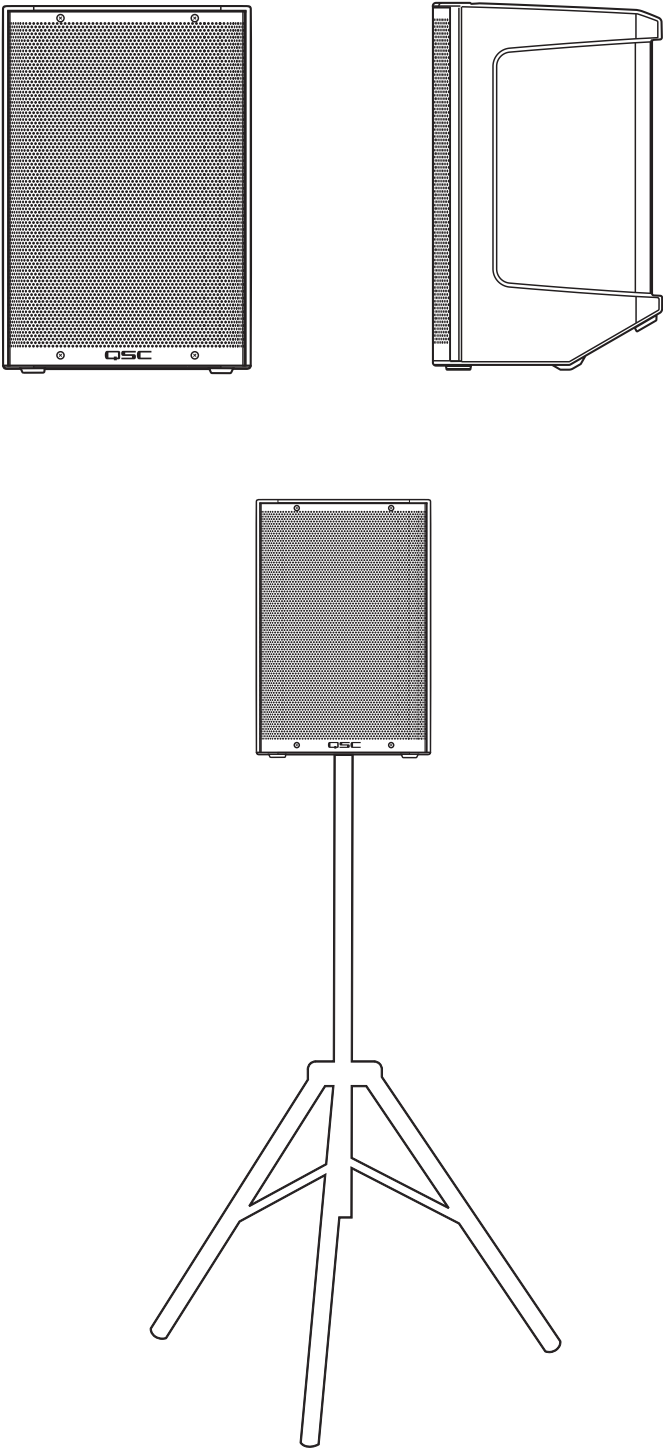

WA-001008-01-A



Contents

- Maintenance and Repair4
- Battery Handling and Charging5
- Description of Symbols5
- Regulatory Statements6
 - United States6
 - Brazil6
 - Canada6
 - 中国7
 - EU7
 - Thailand9
 - Singapore9
 - 臺灣10
- Introduction11
 - Key Features and Technologies11
 - QSC Loudspeaker Control APP11
 - What’s in the Box12
- Deployment and Battery Operation.13
 - Applications13
 - Battery Charging13
 - Deployment and Coverage13
 - Battery Removal and Installation14
- Rear Panel Connections and Controls15
 - System Power Sequencing15
 - Inputs15
 - Power, Limiter, and Battery Charge LEDs16
 - Outputs17
 - AC Mains17
 - Approved Batteries List17
 - Firmware Updates17
- Hook Up Diagram.18
- Specifications18
 - Knowledge Base19
 - Customer Support19
 - Warranty19

EXPLANATION OF SYMBOLS

The term “**WARNING!**” indicates instructions regarding personal safety. If the instructions are not followed, the result may be bodily injury or death.

The term “**CAUTION!**” indicates instructions regarding possible damage to physical equipment. If these instructions are not followed, it may result in damage to the equipment that may not be covered under the warranty.

The term “**IMPORTANT!**” indicates instructions or information that are vital to the successful completion of the procedure.

The term “**NOTE**” is used to indicate additional useful information.



NOTE: The intent of the lightning flash with arrowhead symbol in a triangle is to alert the user to the presence of un-insulated “dangerous” voltage within the product’s enclosure that may be of sufficient magnitude to constitute a risk of electric shock to humans.



NOTE: The intent of the exclamation point within an equilateral triangle is to alert the user to the presence of important safety, and operating and maintenance instructions in this manual.



IMPORTANT SAFETY INSTRUCTIONS



WARNING!: TO PREVENT FIRE OR ELECTRIC SHOCK, DO NOT EXPOSE THIS EQUIPMENT TO RAIN OR MOISTURE.



WARNING!: While it is possible for one person to lift a CB10 loudspeaker, it is important to use proper lifting techniques. Suggested reading: OSHA Technical Manual on Back Disorders and Injuries. (http://www.osha.gov/dts/osta/otm/otm_vii/otm_vii_1.html#app_vii:1_2).

1. Read, keep, and follow these instructions.
2. Heed all warnings.
3. Do not use this apparatus near water.
4. Clean only with a dry cloth.
5. Do not block any ventilation opening. Install in accordance with the manufacturer’s instructions.
6. Do not install near any heat sources such as radiators, heat registers, stoves, or other apparatus (including amplifiers) that produce heat.
7. Do not defeat the safety purpose of the polarized or grounding-type plug. A polarized plug has two blades with one wider than the other. A grounding type plug has two blades and a third grounding prong. The wide blade or the third prong are provided for your safety. If the provided plug does not fit into your outlet, consult an electrician for replacement of the obsolete outlet.
8. Protect the power cord from being walked on or pinched particularly at plugs, convenience receptacles, and the point where they exit from the apparatus.
9. Only use attachments/accessories specified by the manufacturer.
10. Unplug this apparatus during lightning storms or when unused for long periods of time.
11. Refer all servicing to qualified service personnel. Servicing is required when the apparatus has been damaged in any way, such as power-supply cord or plug is damaged, liquid has been spilled or objects have fallen into the apparatus, the apparatus has been exposed to rain or moisture, does not operate normally, or has been dropped.
12. The appliance coupler, or the AC Mains plug, is the AC mains disconnect device and shall remain readily operable after installation.
13. Adhere to all applicable, local codes.

14. To prevent electrical shock, the power cord shall be connected to a mains socket outlet with a protective earthing connection.
15. Consult a licensed, professional engineer when any doubt or questions arise regarding a physical equipment installation.
16. Do not use any aerosol spray, cleaner, disinfectant or fumigant on, near or into the apparatus. Clean only with a dry cloth.
17. Do not unplug the unit by pulling on the cord, use the plug.
18. Do not submerge the apparatus in water or liquids.
19. Keep ventilation opening free of dust or other matter.
20. To reduce the risk of fire or electrical shock, do NOT expose this product to rain, liquids or moisture.
21. Do NOT expose this product to dripping or splashing, and do not place objects filled with liquids, such as vases, on or near the product.
22. Keep the product away from fire and heat sources. Do NOT place naked flame sources, such as lighted candles, on or near the product.
23. Do NOT make unauthorized alterations to this product.
24. The maximum ambient temperature during use of the appliance must not exceed 50° C.
25. Do not place or install the product near any heat sources, such as fireplaces, radiators, heat registers or other apparatus (including amplifiers) that produce heat.
26. The product label is located on the back of the product.
27. The product contains small parts which may be a choking hazard. Not suitable for children under age 3.



28. This product contains magnetic material. Consult your physician on whether this might affect your implantable medical device.



CALIFORNIA WARNING: CAN EXPOSE YOU TO LEAD, A CARCINOGEN AND REPRODUCTIVE TOXICANT. SEE WWW.P65WARNINGS.CA.GOV.

Maintenance and Repair

The CB10 loudspeaker does not contain user-serviceable parts. QSC does not recommend using chemicals or solvents to wash loudspeakers. Instead, use a damp towel with water only, and dry immediately after wiping down. Do not allow water to pool on the connectors, hardware, or rear user interface.

If exposed to direct sunlight for extended periods of time, the hardware may become discolored or faded. Cover or shade your CB10 loudspeaker from long-term, direct sunlight whenever possible.



WARNING!: Advanced technology, e.g., the use of modern materials and powerful electronics, requires specially adapted maintenance and repair methods. To avoid a danger of subsequent damage to the apparatus, injuries to persons and/or the creation of additional safety hazards, all maintenance or repair work on the apparatus should be performed only by a QSC authorized service station or an authorized QSC International Distributor. QSC is not responsible for any injury, harm or related damages arising from any failure of the customer, owner or user of the apparatus to facilitate those repairs.

Life Cycle: 10 years, **Storage Temperature range:** -20 C and +60 C, **Relative Humidity range:** 5 - 85% RH.

Battery Handling and Charging



1. Use only approved batteries with the CB10 loudspeaker (see list of approved batteries in the "Approved Batteries List."). The battery pack is not compatible with other systems. Use with other systems may result in a risk of fire, electric shock or personal injury.
2. Fully charge battery before first use.
3. Do not charge battery packs in rain, snow, damp or wet locations.
4. Do not submerge the battery in water or liquids.
5. Do not use battery pack in the presence of explosive atmospheres because sparks may be generated when inserting or removing battery pack possibly causing fire
6. Use only QSC approved charging devices.
7. Do not expose battery to high temperatures (above 60°C / 140°F); External heat sources (e.g., open flames, heaters, etc.) can also accelerate failure in cells with defects or damage from other causes.
8. Do not subject battery to extremely low air pressure.
9. Battery must not be subjected to mechanical shock. There is a risk of the battery being damaged.
10. Do not burn or incinerate battery packs. Battery packs may explode, causing personal injury or damage. Toxic fumes and materials are created when battery packs are burned.
11. Do not puncture or crush, drop, or damage battery packs.
12. Do not disassemble. Incorrect reassembly may result in the risk of electric shock, fire or exposure to battery chemicals. If it is damaged take it to a QSC service facility.
13. Do not short circuit.
14. Do not use a battery pack that has received a sharp blow, been dropped, run over, or damaged in any way. Before use, inspect the battery for signs of damage, such as bulging/cracking, hissing, leaking, rising temperature, and smoking. Immediately remove a device or battery from service and place it in an area away from flammable materials if any of these signs are present.



WARNING!: There is the risk of explosion or leakage of flammable liquid or gas if:

- Replacing a battery with an incorrect type that can defeat a safeguard (for example, in the case of some lithium battery types)
- Disposing of a battery into fire or a hot oven, or mechanically crushing or cutting a battery
- Leaving a battery in an extremely high temperature surrounding environment
- Subjecting a battery to extremely low air pressure

Description of Symbols

	<p>RECYCLING</p> <p>This product bears the selective sorting symbol for Waste electrical and electronic equipment (WEEE). This means that this product must be handled pursuant to European directive 2012/19/EU in order to be recycled or dismantled to minimize its impact on the environment.</p> <p>User has the choice to give his product to a competent recycling organization or to the retailer when he buys a new electrical or electronic equipment.</p>
	Alternating current
	Read user manual before use

Regulatory Statements

United States

This device complies with Part 15 of the FCC Rules. Operation is subject to the following two conditions: (1) This device may not cause harmful interference. (2) This device must accept any interference received, including interference that may cause undesired operation.

NOTE: This equipment has been tested and found to comply with the limits for a Class A digital device, pursuant to part 15 of the FCC Rules. These limits are designed to provide reasonable protection against harmful interference when the equipment is operated in a commercial environment. This equipment generates, uses, and can radiate radio frequency energy and, if not installed and used in accordance with the instruction manual, may cause harmful interference to radio communications. Operation of this equipment in a residential area is likely to cause harmful interference in which case the user will be required to correct the interference at his own expense.



WARNING!: Changes or modifications not expressly approved by the party responsible for compliance could void the user's authority to operate the equipment.

Radiation Exposure Statement

NOTE: This equipment complies with FCC radiation exposure limits set forth for an uncontrolled environment. This equipment should be installed and operated with minimum distance 20cm between the radiator & your body.

Brazil

Este produto está homologado pela ANATEL, de acordo com os procedimentos regulamentados pela Resolução n°. 242/2000 e atende aos requisitos técnicos aplicados. Este equipamento não tem direito à proteção contra interferência prejudicial e não pode causar interferência em sistemas devidamente autorizados. Para maiores informações, consulte o site da ANATEL – www.anatel.gov.br



WARNING!: This device is designed as professional equipment and is intended for commercial or industrial use only. The use and installation of the equipment must be carried out by trained personnel to avoid damage to the equipment of other hazards.

Canada

CAN ICES (A) / NMB(A)

This device complies with Industry Canada licence-exempt RSS standard(s). Operation is subject to the following two conditions:

- (1) this device may not cause interference, and
- (2) this device must accept any interference, including interference that may cause undesired operation of the device.

Le présent appareil est conforme aux CNR d'Industrie Canada applicables aux appareils radio exempts de licence. L'exploitation est autorisée aux deux conditions suivantes :

- (1) l'appareil ne doit pas produire de brouillage, et
- (2) l'utilisateur de l'appareil doit accepter tout brouillage radioélectrique subi, même si le brouillage est susceptible d'en compromettre le fonctionnement.

RF Exposure

This device has been evaluated and shown compliant with the RF exposure requirements listed in RSS-102 - Radio Frequency (RF) Exposure Compliance of Radio communication Apparatus limits under fixed exposure conditions (antennas are greater than 20cm from a person's body) when installed in certain specific OEM configurations.

Cet appareil a été évalué et montré conforme aux exigences d'exposition RF énumérées dans RSS-102 - Exposition aux fréquences radio (RF) Conformité des limites des appareils de communication radio dans des conditions d'exposition fixes (les antennes sont à plus de 20 cm du corps d'une personne) lorsqu'elles sont installées dans certaines configurations OEM spécifiques.

中国

 仅适用于海拔2 000m及以下地区安全使用
Used only at altitudes not more than 2000m above sea level

 本产品的环保使用年限为10年
The environmental protection use period of the product is 10 years

The CB10 loudspeakers are in compliance with “中国 RoHS” directives. The following table is provided for product use in 中国 and its territories.

中国RoHS声明

产品中有害物质的名称及含量

部件名称	有害物质					
	铅 (Pb)	汞 (Hg)	镉 (Cd)	六价铬 (Cr(VI))	多溴联苯 (PBB)	多溴二苯醚 (PBDE)
金属部件	○	○	○	○	○	○
塑胶部件	○	○	○	○	○	○
印刷电路板	○	○	○	○	○	○
扬声器	○	○	○	○	○	○
电池组	X	○	○	○	○	○

本表格依据SJ/T11364的规定编制。

O: 表示该有害物质在该部件所有均质材料中的含量均在GB/T 26572-2011规定的限量要求以下。

X: 表示该有害物质至少在该部件的某一均质材料中的含量超过GB/T 2657-2011限定的限量要求。

根据中国电子行业标准SJ/T11364-2014 和相关的中国政府法规, 本产品及其某些内部或外部组件上可能带有环保使用期限标识。取决于组件和组件制造商产品及其组件上的使用期限标识可能有所不同。组件上的使用期限标识优先于产品上任何与之相冲突的或不同的环保使用期限标识。

EU

Technical Specifications

- Operating Frequency Range: 2402-2480 MHz
- Max. RF Output power: < 20dBm E.I.R.P
- Temperature range: 0 to 50° C
- Software version: TBD

This product can be used in EU countries without any restrictions.

Manufacturer Information

QSC, LLC
1675 MacArthur Blvd. Costa Mesa, CA 92626, USA

EU Representative

QSC EMEA GmbH
AM Ilvesbach 6, 74889 Sinsheim, Germany
Tel: +49 7261 6595 300
Email: info.emea@qsc.com
www.qsc.com

EU Regulatory Conformance

Hereby, we (QSC, LLC) declared that this device is in compliance European Radio Equipment Directive (RED) 2014/53/EU and European Restriction of Hazardous Substances (RoHS) Directive 2011/65/EU.

The full text of the EU declaration of conformity is available at the following internet address:

<https://www.qscaudio.com/resources/compliance-library/>

RF Exposure Statement

RF exposure assessment has been performed to prove that this unit will not generate the harmful EM emission above the reference level as specified in EC Council Recommendation (1999/519/EC).



WARNING!: Operation of this equipment in a residential environment could cause radio interference.

Correct Disposal



Do not dispose of this product with the normal household waste at the end of its life cycle. Return it to a collection point for the recycling of electrical and electronic devices. This is indicated by the symbol on the product, user manual or packaging. The materials are reusable according to their markings. By reusing, recycling or other forms of utilisation of old devices you make an important contribution to the protection of our environment. Please contact your local authorities for details about collection points.

Thailand

เครื่องโทรคมนาคมแล้ ้มีความสอดคล้องตามมาตรฐานหรือข้อกำหนดทางเทคนิคของ กสทช.



Singapore



臺灣

根據低功率射頻器材技術規範：

取得審驗證明之低功率射頻器材，非經核准，公司，商號或使用者均不得擅自變更頻率、加大功率或變更原設計之特性及功能。低功率射頻器材之使用不得影響飛航安全及干擾合法通信；經發現有干擾現象時，應立即停用，並改善至無干擾時方得繼續使用。前述合法通信，指依電信管理法規定作業之無線電通信。低功率射頻器材須忍受合法通信或工業、科學及醫療用電波輻射性電機設備之干擾。

限用物質含有情況標示聲明書

設備名稱：主動式喇叭，型號：CB10						
單元 Unit	限用物質及其化學符號 Restricted substances and its chemical symbols					
	鉛 (Pb)	汞 (Hg)	鎘 (Cd)	六價鉻 (Cr+6)	多溴聯苯 (PBB)	多溴二苯醚 (PBDE)
金屬部件	○	○	○	○	○	○
塑膠部件	○	○	○	○	○	○
印刷電路板	○	○	○	○	○	○
喇叭	○	○	○	○	○	○
電池組	-	○	○	○	○	○
<p>備考1.“超出0.1 wt%”及“超出0.01 wt%”係指限用物質之百分比含量超出百分比含量基準值。</p> <p>Note 1: "Exceeding 0.1 wt %" and "exceeding 0.01 wt %" indicate that the percentage content of the restricted substance exceeds the restricted substance exceeds the reference percentage value of presence condition.</p> <p>備考2.“○”係指該項限用物質之百分比含量未超出百分比含量基準值。</p> <p>Note 2. "O" indicates that the percentage content of the restricted substance does not exceed the percentage of reference value of presence.</p> <p>備考3.“—”係指該項限用物質為排除項目。</p> <p>Note 3: The "-" indicates that the restricted substance corresponds to the exemption.</p>						

Introduction

Building on the ultra-compact and class-leading value of the C Class, CP Series loudspeakers, the CB10 is a 2-way 10-inch, portable, AC or battery powered PA loudspeaker that delivers unprecedented performance. Multiple inputs, custom presets, onboard DSP, Bluetooth audio streaming, and a remote control app for iOS and Android make it the idea loudspeaker for event production, solo and duo performances, or any other application that demands high quality audio in remote areas or where local power is not easily available.





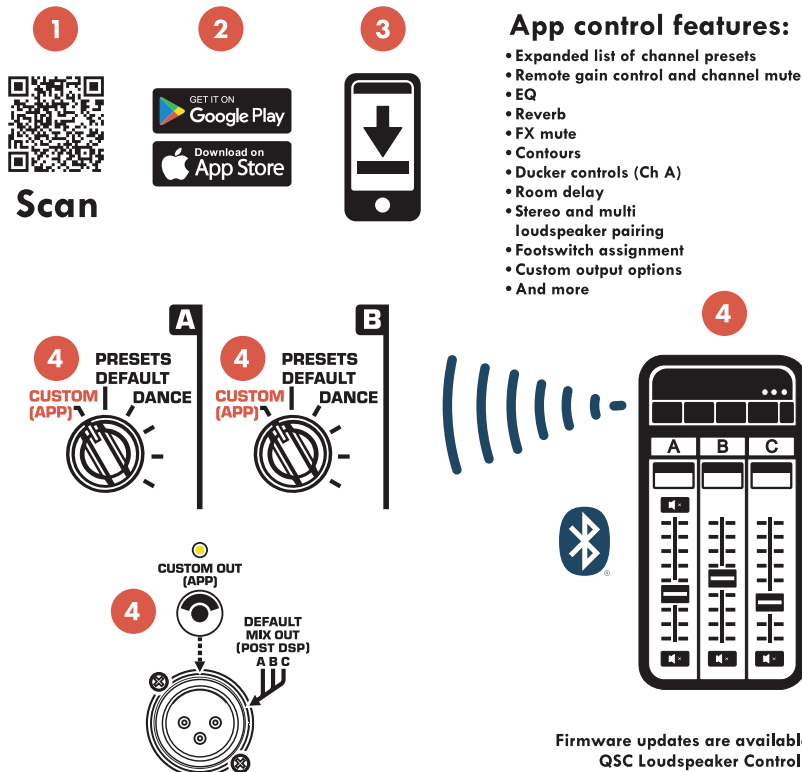

Key Features and Technologies

- **2-way** active loudspeaker system featuring a 10-inch woofer and a 1-inch (25.4 mm) HF compression driver.
- Very high, undistorted maximum peak SPL.
- Ultimate portability with the on-board, removable and **rechargeable battery**.
- **AC power** connection allows optimum performance without time constraints.
- Integrated **room delay** supports use as a system extension with larger PA deployments.
- **Intuitive rear panel control** with expanded control via the Bluetooth QSC Loudspeaker Control App ensures confidence with simple plug-and-play operation while also supporting deeper customization via convenient software control.
- Two combo **XLR inputs** (Line/Mic), with independent, assignable Factory Presets for each input, perfect for small events where two microphones are needed for different use.
- **Bluetooth** Audio featuring True Wireless Stereo (TWS), which ensures low-latency pairing between music source and connections of up to 4 loudspeakers, simultaneously.
- **Pole mount and tilt-back placement** supports a variety of deployment options.
- **QSC Acoustic Linear Phase (ALP)** integration means that the CB10 can be seamlessly combined with QSC subwoofers for additional low-frequency support when needed.
- Industry-best global **6-Year Extended Warranty** when registered within 30 days of purchase (1-year battery warranty).

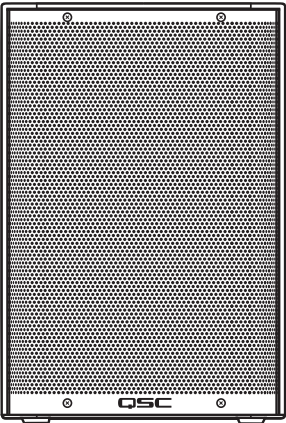
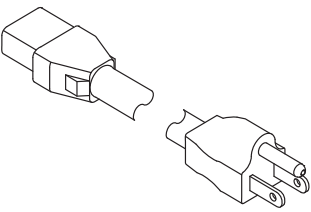
QSC Loudspeaker Control APP



What’s in the Box

	(1) CB10 Loudspeaker		(1) AC Power cord
	(1) White QSC Logo Decal		(1) QSC Limited Warranty TD-000453
	(1) CB10 Quick Start Guide TD-001711		(1) Powered Loudspeaker Safety Sheet TD-001726
	(1) Battery Safety and Regulatory Statements TD-001725		

Deployment and Battery Operation

Applications

The CB10 is equipped with a rechargeable battery making it ideal for use where power is not available or easily accessible. The CB10 loudspeaker can also be used with AC power for extended use and performance. The rechargeable battery is charged in the loudspeaker itself when connected to AC power and is easily removed and replaced without tools, if needed.

Battery Charging

1. Battery level can be checked using the battery charge level LED indicators on the rear panel or by using the QSC Loudspeaker Control app when connected via Bluetooth.
2. To charge the battery simply connect the loudspeaker AC power with the battery installed in the CB10. This will safely charge the battery while also allowing the loudspeaker to be used under AC power.
3. When charging is complete, you can disconnect the AC power from the CB10 loudspeaker for storage. If the CB10 is still in use while fully charged, AC power can remain connected.

Deployment and Coverage

The CB10 can be floor mounted (0° or 30° tilt) or pole mounted. Acoustic coverage is 90° x 90°.

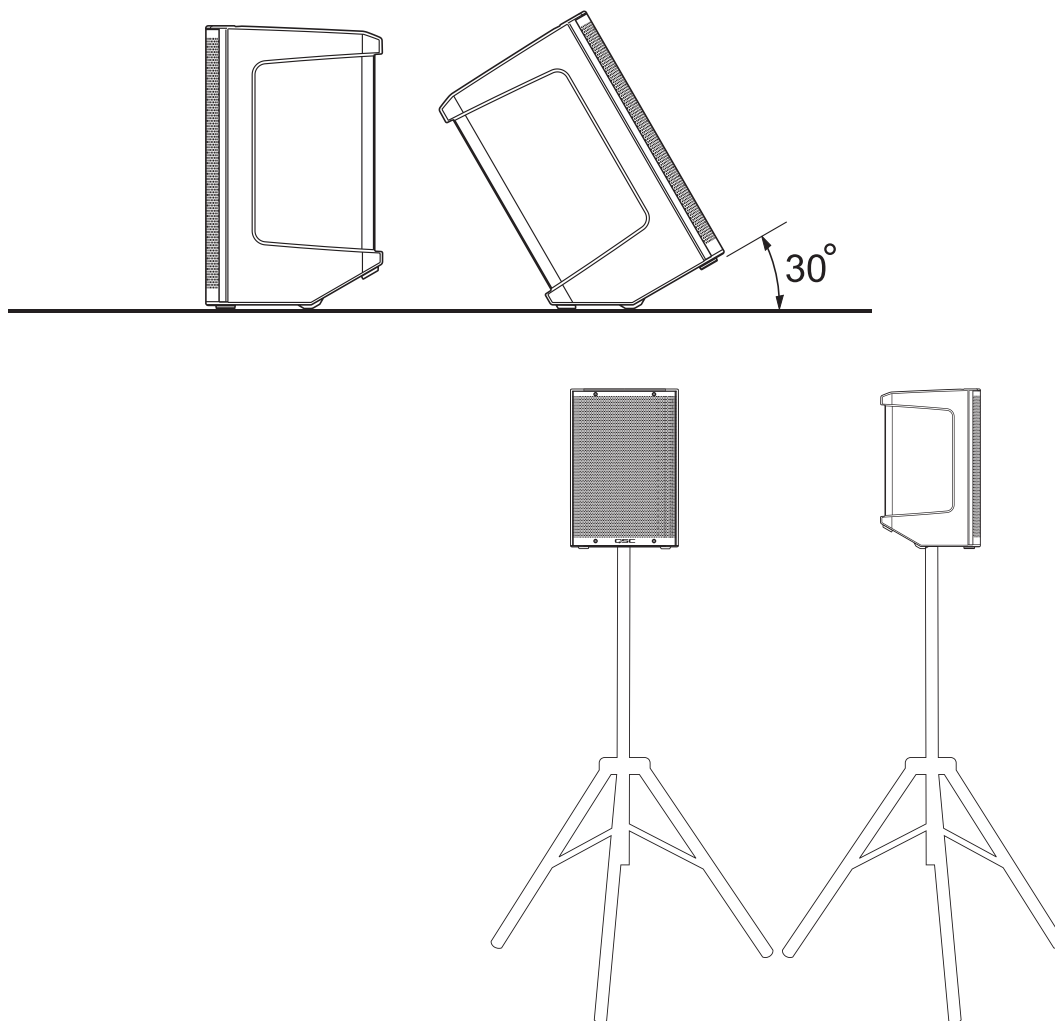

Battery Removal and Installation

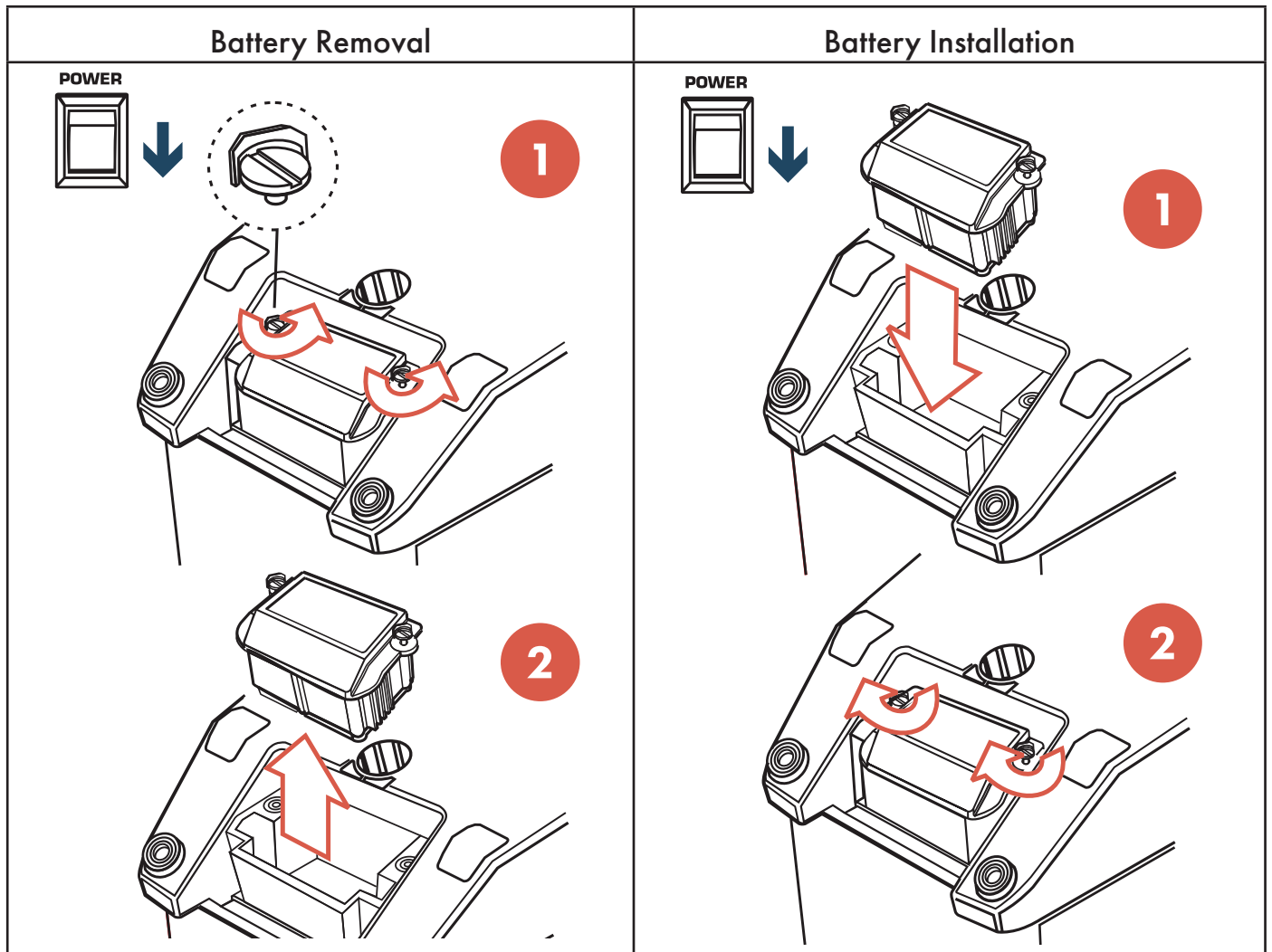

CAUTION!: When replacing the battery, use only QSC-approved battery modules.

Rear Panel Connections and Controls

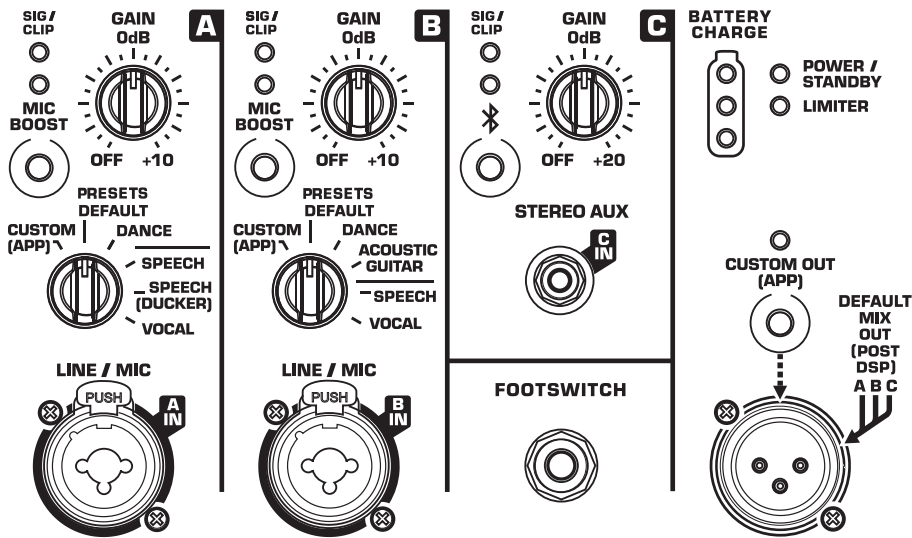

System Power Sequencing

Proper power turn on/turn off sequencing can help to prevent unexpected sounds from being produced by the system (pops, clicks, thumps). Always follow the rule that loudspeakers are “last on, first off”.

Power On Sequence: Bring the output level control of the mixer (or other audio source) feeding your loudspeakers to its minimum position. Turn on all source devices (CD players, mixers, instruments), then turn on the CB10 Battery Powered Loudspeaker. The level controls on your mixer may now be brought up.

Power Off Sequence: Turn off CB10 Battery Powered Loudspeaker, then turn off all source devices. Any device being driven from the output of a CB10 via the ASSIGN OUTPUT should be turned off before the signal of the CB10 feeding it is powered off.

Inputs

Inputs A & B

- SIG LED** – When illuminated **green**, it indicates a signal is present. When illuminated **red**, it indicates that the A/D converter is being clipped, and gain should be reduced until no longer flashing red. If this LED is not illuminated, the input signal is missing or too low to be detected.
- MIC BOOST button** – This button boosts the input level to accept a microphone input. When MIC BOOST is not ON, the input is configured for a line-level input. The MIC BOOST setting should only be used if a microphone is connected directly to the MIC/LINE input. Note that the input does not provide +48V phantom power.
- GAIN control** – Sets the sensitivity of Input A or B which controls the signal level sent to the amplifier and the ASSIGN OUT (POST DSP) output. The physical GAIN control on the loudspeaker may be overridden by adjustments made in the QSC Loudspeaker Control App. To restore manual control, either match the physical GAIN knob to the app’s current setting, or turn the knob to OFF and then raise it again.
- CONTOUR knob** – Selects the input preset contour setting. This allows you to customize the input DSP to be optimized based on the input source type. When set to CUSTOM (APP) the input DSP will use the settings configured using the Bluetooth QSC Loudspeaker Control app which provides additional customized control of the input DSP settings.
- Combination XLR – 1/4-in Jack** – Balanced XLR and 1/4-in input. Accepts line-level or MIC-level.

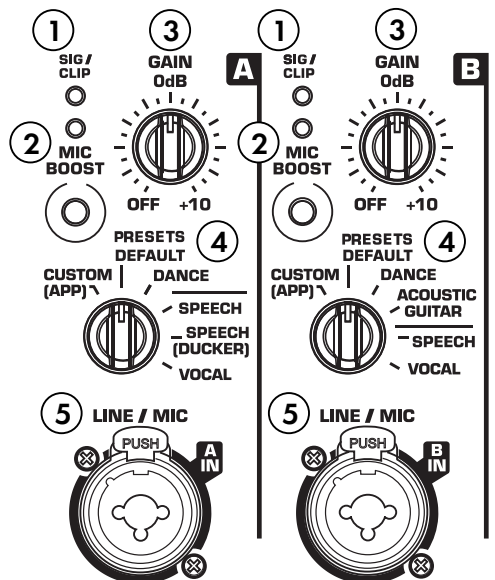

Input C

1. **SIG LED** – When illuminated **green**, it indicates a signal is present. When illuminated **red**, it indicates that the A/D converter is being clipped, and gain should be reduced until no longer flashing red. If this LED is not illuminated, the input signal is missing or too low to be detected.
2. **Bluetooth button** – This button is used to activate/deactivate Bluetooth connectivity. Short press to activate Bluetooth pairing mode and to connect a Bluetooth streaming host device such as a phone or tablet. For additional Bluetooth functionality such as multicasting and stereo mode, please refer to the QSC Loudspeaker Control app instructions. To unpair or deactivate the Bluetooth connection, press and hold this button for 5 seconds.
3. **Bluetooth LED** – This LED indicates the status of Bluetooth connection. When blinking rapidly, the Bluetooth module is searching for a host device to pair with. When the LED is solid **blue**, the Bluetooth module is connected to a host device. If the LED is not illuminated, Bluetooth is not activated.
4. **GAIN knob** – Sets the sensitivity of Input C **and** Bluetooth, which controls the signal level sent to the amplifier and the MIX OUT (POST DSP) output.
5. **Stereo 1/8-in (3.5 mm) TRS connector** – Accepts line-level stereo input. Stereo input received at Input C is summed to mono.

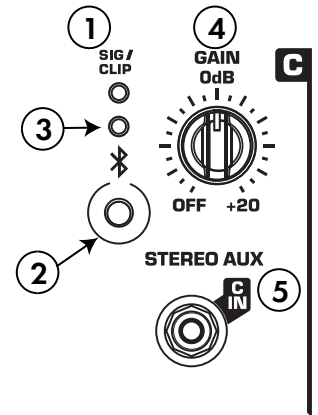

Footswitch Connector

Connect an external momentary or latching tip-to-ground foot switch to control FX mute, Ducker on/off, loudspeaker mute and more. The default setting is for a latching footswitch. To change the function of the foot switch or foot switch type, please refer to the QSC Loudspeaker Control app instructions.

FOOTSWITCH



Power, Limiter, and Battery Charge LEDs

1. **POWER / STANDBY LED** – Illuminates **blue** when power is applied to the unit and the ON/OFF switch is in the UP position.
 - » After 5 minutes of no signal detected, the CB 10 loudspeaker will go into standby mode, and the power LED will pulse slowly (standby mode)
 - » The CB10 loudspeaker can be "woken up" from standby by either sending signal to the loudspeaker, connecting the Bluetooth QSC Loudspeaker Control app, or power-cycling the loudspeaker.
 - » The CB10 will not go into standby if Bluetooth connection is active.
 - » After 30 minutes of being in standby mode, the CB10 will enter a low-power consumption mode that preserves the battery life when the loudspeaker is left unattended. In this mode all LED's are off, and no audio will pass, even though the POWER switch is in the UP position. To wake the CB10 from low-power consumption mode simply toggle the power switch down and back up again to resume normal use. This low-power consumption mode is on by default but can be disabled in the loudspeaker settings when using the QSC Loudspeaker Control app.
2. **LIMITER LED** – Illuminates **red** when the built-in limiter is activated to protect and avoid damage to the amplifier or loudspeaker. If the signal level at any frequency is too high, or the amplifier is too hot, the limiter is activated and the LED is illuminated.
3. **BATTERY CHARGE LEDS** – Indicates the charge status of the rechargeable battery:
 - » When fully charged all 3 LEDs are green.
 - » When 75% battery capacity is left only 2 LED's will show green.
 - » When 25% battery capacity is left only 1 LED will show green.
 - » When 10% battery is left the bottom LED will turn red until there is no power remaining.
 - » When charging, the LEDs will slow pulse as follows: the single, bottom LED pulses when less than 25% charged, the bottom and middle LEDs pulse when more than 75% is charged, and all 3 LED's will be ON when fully charged.

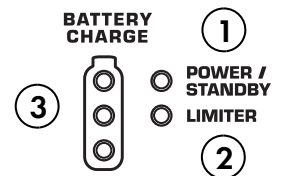

Outputs

1. **OUTPUT** – Analog pass-through XLR that by default outputs a mix of the A+B+C+Bluetooth inputs.
2. **CUSTOM OUT button** – In addition to the default output configuration, the CB10 supports customizing the output to Source A only, Source B only, and to A+B+C, without Bluetooth, via the QSC Loudspeaker Control app.

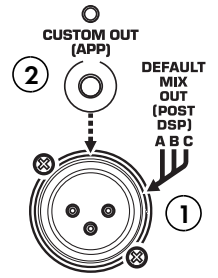

AC Mains

Connect AC power to the IEC socket on the back of the amplifier by locating the IEC connector-end of the AC power cord and inserting it fully into the IEC inlet on the power amplifier module.

NOTE: Turn off the AC power switch before connecting AC power.

When AC power is connected to the CB10 loudspeaker, the battery will be charging until fully charged regardless of the power switch being on or off.

The CB10 loudspeaker is fed by a universal power supply. This power supply is capable of operating the system with input AC power voltages ranging from 100 - 240 VAC, at 50 – 60 Hz.

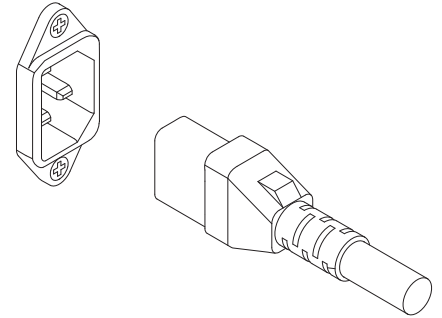

CAUTION!: Use only the power cable that is correct for your location.

Power Switch

Push in on the top of the rocker switch to apply AC mains power to the CB10 loudspeaker. Push in on the bottom of the rocker switch to turn the unit off.

POWER

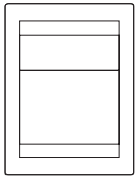

Approved Batteries List

Use only the batteries listed below with the CB10 loudspeaker:

- CB10-BATTERY

Firmware Updates

To ensure optimal performance, keep your CB10 up-to-date by installing firmware updates through the QSC Loudspeaker Control App. Simply follow the in-app instructions to access the latest firmware.

Hook Up Diagram

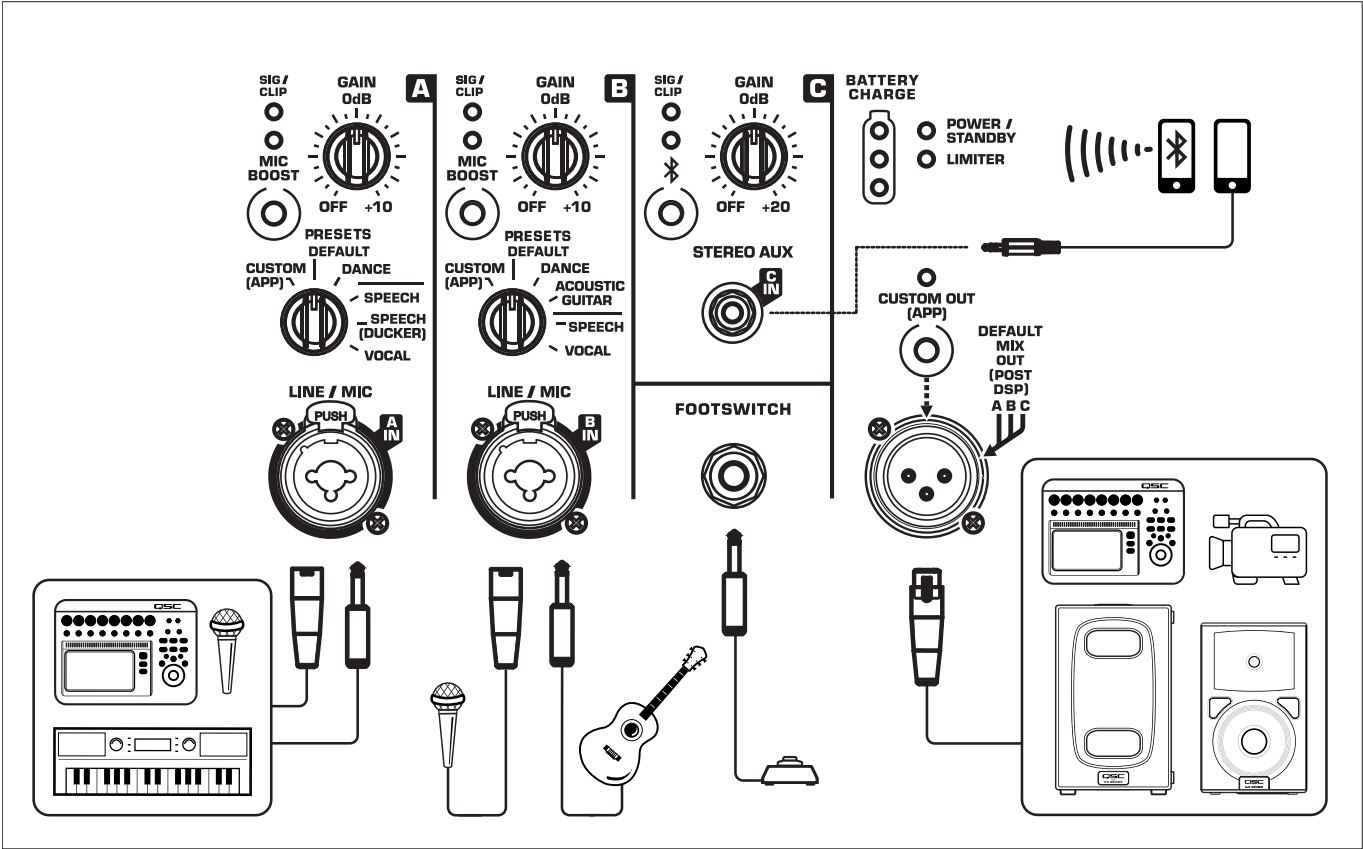

Specifications

Specifications for the QSC CB10 can be found at [qscaudio.com](https://www.qscaudio.com).



Knowledge Base

Find answers to common questions, troubleshooting information, tips, and application notes. Link to support policies and resources, including software and firmware, product documents, and training videos. Create support cases.
support.qsc.com

Customer Support

Refer to the Contact Us page on the QSC website for Technical Support and Customer Care, including their phone numbers and hours of operation.
qscaudio.com/contact-us/

Warranty

For a copy of the QSC Limited Warranty, go to:
qscaudio.com/support/warranty-statement/

© 2025 QSC, LLC. All Rights Reserved.

QSC, LLC's trademarks include but are not limited to QSC® and all trademarks are listed under www.qsc.com/trademarks, some of which are registered in the U.S. and/or other countries.